

Grindings

Idaho Gem Club, Inc.

P.O. Box 8443 ▼ Boise, Idaho 83707-2443

VOL 69 NO 5

May 2009



BOARD OF DIRECTORS

Tony Griffin
President
467-9286

Willa Renken
1st Vice President
362-3941

Phil Neuhoff
2nd Vice President
939-4508

RECORDING SECRETARY
Jason Madsen
378-4666

Joe Nielson
362-3522

Ed Moser
340-8060

Terry Tomberlin
343-7506

Twila Gallaher
853-6703

Dan Phillips
585-3019



TREASURER
Kathy Griffin
467-9286

NFMS DIRECTOR
Charles McCreath
344-5085

EDITOR
Doug Renken
362-3941
WLR_DKR@MSN.COM

CLUB WEB SITE
www.idahogemclub.com

President's Message

Gov. Butch Otter signed into law "Earth Sciences and Lapidary Special License Plate Program" on April 21, 2009. The law will become effective on January 1, 2010. We are still not sure how much each of the clubs will have to pay, the Idaho Transportation Department will let us know in the next few weeks. Starting in January 2010 we will be able to buy this special plate. Again, a great "Thank You" goes to the committee, Charles Osgood, Chuck McCreath, Joe Nielson, Ed Moser, and Gene Stewart, that diligently worked with our Legislature to get this bill made into Law.

There are numerous places for Field Trips in this month of May. The AMFED in conjunction with the Northwest Federation and the California Federation are sponsoring an obsidian dig at Lassen Creek and Davis Creek near the California Oregon border over the Memorial Day Weekend. The AMFED website has a flyer stating there will be other places of interest to visit as well. One of these is "Dust Devil Mine" sunstone dig. See the field trip section of this newsletter for more info.

For those not interested in going to Lassen Creek and Davis Creek there will be an alternate club field trip to Texas Spring, NV for pink limb casts and petrified wood. From Texas Springs we will then travel through Nevada to Delta, Utah for trilobites at the "U-Dig" commercial site west of Delta. This is over the Memorial Day Weekend starting on Friday May 22nd. See inside for more info!

Our first workshop of the year will be held at Doug & Willa Renken's home on May 21st. This is a great opportunity to learn and practice lapidary skills. Many thanks to Doug & Willa for allowing us to congregate at their home and to Marge Conley for sharing her wire wrap knowledge. And thank you to the instructors for their efforts and time to help us learn.

There are numerous new members that have joined our club this year. Many of them come with a great knowledge of geology for us to share. All of them have a desire to learn and share their skills, please take the opportunity to share friendship by getting to know them.

Tony Griffin
President

**MINUTES OF THE IDAHO GEM CLUB
GENERAL MEETING ♦
APRIL 21, 2009**

Tony Griffin called the meeting to order at 7:30 pm.

The Pledge of Allegiance was led by Tony Griffin.

Guests were Phil Tihonovich, Susan and Scott Benda, and Jim Kirshbaum.

Door Prizes were won by Leslie Brown, Shirley McCreath, Phil Thompson, Michael George, Chuck McCreath, Lynne Davis, Larry Riddley, Jim DaSilva, and Curtis Brown.

Joe Nielson presented the building fund door prize to Susan Benda.

A motion was made by Bill Belknap to accept the minutes as printed in the "Grindings". Ron Lambert seconded the motion, and the motion was carried.

New members are Neil Potts and Terra Cole.

Secretary's Report – Jason Madsen presented the secretary's report. The club received the Boulder Buster, Owyhee Gem, and Emerald Gems newsletters.

Treasure's Report – Kathy Griffin presented the treasure's report. She discussed disbursements for the rock show, checking balance and total balance.

Federation Report – Chuck McCreath presented the Federation report. The phone number for the Federation show is in the "Grindings". Ask for Tiffany and let her know that you are attending

the gem and mineral show. There are not any powered RV spaces left. There are a few dry camps left. See page 4 of the April Grindings for information on the show. The Federation website is (<http://www.amfed.org/nfms>).

Committee Reports

R.O.L.E. – Ron Bailey discussed the R.O.L.E. program and advancements on making cabs.

Sunshine Report – Arlene Bailey reported that Larry Riddley's brother in law passed away. Ron Ridenour had surgery. Marion Philips is having back surgery.

Field Trip Report – The field trip report was presented by Tony Griffin. The April trip will be to Shell Hill for snail fossils and obsidian nodules. The group will meet at Kmart at 8:00 am and leave at 8:30 am. Bring a ¼ inch screen, rake, and shovel.

Librarian Report – Terry Tomberline presented the librarian's report. There are several old newsletters that are being cleaned out if anyone wants them.

Junior's Report – Ed Moser reported on the juniors. They will receive sample minerals and petrified wood. Chuck and Shirley McCreath were presented with a thank you for appreciation for the presentation they did at Horizon Elementary. Chuck also led a group of Cub Scouts and their parents on a trip to the Owyhee's last weekend.

Assistant Show Chair – Doug Renken reported that next year's show will be on February 27 and 28. If you want anything in the newsletter let Doug know.

Workshop Report – Willa Renken discussed the workshop for making cabs. If there

General minutes continued from page 2

are some specifics on what you want to learn let Willa know. The work shop will resume on May 21 at 6:30 pm at the Renken’s shop. Marge Conley will be there to teach wire wrapping. A map and phone number to the Renken’s is in the Grindings.

Unfinished Business

License Plate – Charles Osgood reported that the Gem License Plate bill has passed the Senate and the House. It is currently on the Governor’s desk waiting to be signed.

New Business

Joe Nielsen discussed the clubs interests in buying new shirts and possibly hats with the clubs logo on them. The majority of the club approved ordering the shirts.

The meeting was adjourned at 8:30 pm.

The program was on the Omnibus Law and was presented by Phil Neuhoff.

*Respectfully submitted,
Jason Madsen
Secretary*

**MINUTES OF THE IDAHO GEM CLUB
BOARD MEETING ♦
MAY 5, 2009**

Tony Griffin called the meeting to order at 7:32 pm.

The following board members and officers were present: Tony Griffin, Kathy Griffin, Chuck McCreath, Willa Renken, Joe Nielsen, Ed Moser, Terry Tomberlin, Twila Gallaher, Phillip Neuhoff, Dan Phillips, and Jason Madsen. Guests were: Doug Renken, Linda Phillips, Arlene Bailey, Ron Bailey, Shirley McCreath, Lynne Davis, and Charlie Smith.

Willa Renken moved to accept the minutes as printed in the “Grindings”, Terry Tomberlin seconded, and the motion was carried.

Secretary’s Report – Jason Madsen reported that the club had received the Rock Rambler and Rock Licker newsletters and the May 2009 issue of Rock and Gem.

Treasure’s Report – Kathy Griffin gave the treasure’s report. She reported that the Idaho Gem Club income taxes have been filed. She reviewed the checking balance, disbursements, and savings account. The CD #8658 general fund needs renewed. Willa Renken made a motion to place the savings # 8658 in a 12 month CD @ 1.85%. The motion was seconded by Twila Gallaher, and the motion was carried.

Federation Report – The Federation report was given by Chuck McCreath. Camping slots for the Federation show are filled. There will be eight field trips during/after the show. There are 48 vendors with a 27 ounce gold nugget and a 400 pound smoky quartz crystal on display.

Committee Reports

Scholarship – Phil Neuhoff reported that he has been working on some changes to be considered for the scholarship program.

Program for General Meeting – Phil Neuhoff reported that he will have a program for the May meeting on amethyst geodes. There is a possibility for a program on gold prospecting in the future.

Workshop – Willa Renken reported that there will be a workshop on May 21 at 6:30 at the Renken’s shop.

Sunshine Report – Arlene Bailey reported that the club sent a plant to Marion Phillips and

Board minutes continued from page 3

stated that she is doing well. It was also discussed that Ron Ridenour is doing better.

R.O.L.E. – Ron Bailey reported that there is no new information to report on the R.O.L.E. program. Lynne Davis proposed that serpentine and lizardite minerals containing asbestos be removed from the R.O.L.E. program. There was a discussion on making the proposal to the nation level.

Librarian Report – Terry Tomberlin reported that he is welcome to suggestions on books and videos for the Library. The bookcase for the library has been ordered and should be ready this fall.

Junior's Report – Ed Moser reported that there were six juniors that attended the last meeting. They received sample minerals and loupes. A special door prize was won by Ann Cryer and the general door prize was won by Tes Cryer. For the May meeting the juniors will start at the beginning of the meeting. Answers for the April Rock and Gem quiz are on page 42 and 43 of the May issue. The dead line for the May contest is May 31.

Building Fund – Joe Nielsen gave the building fund report. There was discussion of shirts displaying the IGC logo on the front and the Gem License plate insignia on the back. Colors were discussed as well. Joe will have sizes and colors options available at the next board meeting.

Field Trip – Tony Griffin reported that there were 23 adults and 4 juniors that attended the last field trip. The American Federation, Northwest Federation, and the California

Federation will be having fieldtrips near the sunstone location on May 20 - 25. Some members of the club will be going to Delta, Utah for trilobites and Texas Springs, NV. for limb casts the same weekend.

Budget reviews – Charlie Smith reported on the 2010 Gem show budget. A motion was made by Phil Neuhoff to accept the budget, Willa Renken seconded, and the motion was carried. The board gave a unanimous thanks to Charlie and the show committee chairs. Willa Renken presented the 2009 General Budget. A motion was made by Ed Moser to accept the budget, Phil Neuhoff seconded, and the motion was carried.

Unfinished Business

PA system – There was some discussion on getting a PA system. Terry Tomberlin will do some research on PA systems.

License Plates – Chuck McCreath reported that the Governor signed the Gem License plate bill. There is no information yet on when the plates will be available or how much they will cost.

Membership Applications – Applications were received from Stuart Wilcox, Rodney Sharp, Jim Kirschbaum, and Scott and Susan Benda. Ed Moser made a motion to accept the applicants as members, Terry Tomberlin seconded, and the motion was carried.

*Respectfully submitted,
Jason Madsen
Secretary*

April Field Trip Report Shell Hill Field Trip Report

A seasonal morning found us visiting and getting ready for a day of hunting for shell fossils, petrified wood, and obsidian nodules. It was clear, windy and a little cool. Twenty three intrepid rock hounds were present on this Saturday morning, nineteen adults and four youth.

It is quite surprising to find so many obsidian nodules after years of collecting. About $\frac{3}{4}$'s of a mile after reaching the top of the plateau and where the ground appears to be littered with dark gravel you can start finding obsidian nodules. From there to where we turned off to Shell Hill they are in abundance. We spent about twenty minutes collecting obsidian then drove on to collect shells and petrified wood.

The road into Shell Hill wasn't that bad this day. Rod Sharp was able to drive his sedan all the way into the collecting area. After discussing where items of interest have been found in the past, we started collecting. Surprisingly, pieces of petrified wood about the size of a man's thumb were found in veins of sandstone below the hard top cap to the left of the first saddle. Some small, but nice specimens of petrified wood were collected in other areas. Ron Mummey and Neil Potts found some honey colored chalcedony in a vein in similar location as the petrified wood.

Everyone found fossil shells, some shells better than others, but all interesting specimens. Digging in the loose sand and scree didn't produce any better specimens than those collected on the surface. Two or three people reported collecting specimens on the far side of the third butte (rise) to the left of the parking area.

*Tony Griffin
Field Trip Chairman
467-9286 home phone
863-5990 cell phone.
Email: tonygriffin@heritagewifi.com*

Upcoming Show

**Bitterroot Gem & Mineral Society
Bitterroot River Inn
& Conference Center 139 Bitterroot Plaza Dr.
Hamilton, MT 59840
MAY 2009
23rd 10am -6pm
24th 10am - 5pm**

For Sale

I have quite a number of slices of rock for sale.
Some Plume, many kinds of Petrified Wood,
Agate and Jasper.
Call to be sure I'll be home.
You are welcome to come and see what is
available.
Warrine Cottrell (208) 323-1692

HAPPY BIRTHDAY



DATES TO REMEMBER

GENERAL MEETING:
3rd. Tuesday of every month
 May 19, 2009
 Church of the Brethren
 2823 N. Cole Road, Boise, Idaho
 Meeting Starts at 7:30 pm.

BOARD MEETING:
1st. Tuesday of every month
 June 2, 2009
 Church of the Brethren
 2823 N. Cole Road, Boise, Idaho
 Meeting Starts at 7:30 pm.

MAY

- 5/5 Deb Butte
- 5/6 Richard Clark
- 5/6 Jeremy Schuster
- 5/8 Loreli Bouffard
- 5/11 Matthew Scott
- 5/14 Carl Woodland
- 5/16 Mike Witschen
- 5/18 Gerri Whitlach
- 5/19 Twila Gallaher
- 5/20 Camille Ridenour
- 5/21 Amy Watson
- 5/22 Jolie Habersetzer
- 5/22 Janice Egner
- 5/24 Deanna Holloway
- 5/24 Mary Ridley
- 5/25 Jennifer Ashton
- 5/25 Mike Egner
- 5/26 Aaron Ashton
- 5/26 Chuck Fawcett
- 5/27 Joan Dethlefs
- 5/27 Lianna Erickson

JUNE

- 6/3 Keith Chipman
- 6/3 Carolyn Nelson
- 6/7 Devon Beck
- 6/8 Pat Kowalski
- 6/11 Eldon Lutz
- 6/11 Robert L. Turner
- 6/12 Teri Hetherington
- 6/15 Cheryl Ellicott
- 6/15 Sarah Neuhoff
- 6/16 Chris Blickfeldt
- 6/17 Sandy Blodgett
- 6/18 Margaret Loewen
- 6/19 Steve Longstroth
- 6/21 Phillip Morris
- 6/21 Laura Lindsay
- 6/24 Gabrielle Loewen
- 6/26 Gene Snyder
- 6/28 Carol Knudsen
- 6/28 Katherine Deonier
- 6/30 Janine Habersetzer

May Birthstones
Faceted — Emerald
Cabochon —
Chrysoptase

June Birthstones
Faceted — Alexandrite
Cabochon — Moonstone
Traditional — Pearl

SAVE STAMPS

Just a note to remind people to save their postage stamps to donate to the Federation. The stamps are sold and the proceeds are donated to cancer research. Cut at least 1/4 inch margin around the stamps. You can turn them into Chuck McCreath at our next meeting. **THANK YOU!**

May Refreshment Committee

Chair: Deanna Moser 585-2233
 Joe Nielson 362-3522
 Carol Da Silva 938-7728

REFRESHMENT COMMITTEE GUIDELINES

Need approximately 15 dozen cookies. Wrapped door prizes are also needed. Arrive early enough to set up the chairs. The chairperson brings the coffee urn, coffee, punch, cream, sugar, cups and napkins. Afterward, put meeting tables & chairs away, clean kitchen and sweep the room. Gather and take all the trash with you. Don't forget it is the responsibility of the chair for the coming month to pick up the coffeepot, take it home and bring it the next meeting.

June Refreshment Committee

Chair: Amy Watson 362-6413
 Kitty Bryner 323-7985
 Laura Lindsey 703-6133

IDAHO GEM CLUB MAY FIELD TRIP

Memorial Day Weekend

Texas Springs, NV. for pink limb casts, bog wood, petrified wood, and agate. Road conditions permitting, the regular place to collect is off a gravel road a little over twenty five miles south and east of Jackpot, Nevada. After leaving Texas Springs we will travel south on Highway 93 to Ely, Nv., then intersect Highway 50 going east towards Hinckley and Delta, UT.

Travel through Twin Falls, Idaho on Highway 93 to Jackpot. We will meet Saturday May 23rd in the parking lot of the Four Jacks Hotel & Casino at 10 am, leave at 10:30 am. This is located on the south end and right hand side of the highway in Jackpot, Nevada. There is primitive camping available on BLM land at Texas Springs and near Delta, Utah.

Places to stay in Jackpot, Nevada.

Barton's Club 93 Hotel and Casino (800) 258-2937

Cactus Petes Resort Casino (800) 821-1103
Four Jacks Hotel Casino (800) 251-6313
Horseshu Hotel Casino (800) 821-1103
West Star Resort (800) 665-0643

Places to stay in Delta

- Best Western Motor Inn (435) 864-3882
- Budget Motel (435) 864-4533
- Rancher Motel (435) 864-2741
- Deltan Inn Motel (435) 864-5318
- Antelope Valley RV Park (800) 430-0022

The trilobites at "U-Dig" is a fee dig area. <http://www.u-digfossils.com/> Cost is \$42 per 4 hours and \$70 per 8 hours. Youth ages 7 to 16 the cost is \$28 for 4 hours and \$42 for 8 hours. If we have ten or more in our group there is a discount available. They are closed on Sunday!

We can spend Saturday and part of Sunday at Texas Springs or explore other areas in Nevada, then Sunday afternoon or Monday morning we will travel to the "U-Dig" quarry.

Equipment needed: ¼ inch or ½ inch screen, rock hammer, shovel, bag or bucket for specimens collected, appropriate clothing for the weather and location, food for the time you will be away from home, water, fuel, and any items you need for your personal use. If you would like more information, please come to our Gem Club Meeting: May 19th, 7:30 p.m. at the Mountain View Church of the Brethren 2833 N. Cole Rd. or Call our Field Trip Chairman

Tony Griffin
Field Trip Chairman
467-9286 home phone
863-5990 cell phone.
Email: tonygriffin@heritagewifi.com

OWYHEE GEM & MINERAL SOCIETY MAY FIELD TRIP

Trip Location: Coal Miners Basin, looking for Petrified wood

Date of Trip: Saturday, May 23rd

Meeting Place: ION junction, west of Marsing Idaho where Highway 55 and 95 meet.

Leave Time: Meet 7:30 a.m. leave 8:00 a.m.

Comments: Before the next meeting we will go out and ride the road to make sure we can get in. If the road is not passable we will go to Hooker Creek which isn't much farther down the road. We will be collecting Petrified wood there as well. Bring a rock hammer, shovel, water and lunch.

Walter Barnett
(541) 889-3672

Yesteryear January 1955

January of 1955 started out with 157 paid up members. The February show was finalized and many of the members brought rocks to be sold to defray the cost.

After discussions a motion was made to change the by laws so the fiscal year would coincide with the fiscal year of the Federation in January. Motion passed, a committee was appointed to investigate and make the findings relative to the fiscal year and make the change in it.

In discussing the February Gem Show it was decided that more Individually owned cases were needed of uniform size. (The cases were built ½ as deep as the ones we use now but of the same size otherwise. They didn't break down, but had a glass front same as we do now)

The monthly field trip was to the clubs Amythest mine. Mr. Beckwith stated there would be many interesting things to be found there such as fossils, petrified limb wood, clam shells, Amethystine, and possibly pine cones. They would do the assessment at this time; also do the work on the Morrisonite claim over Memorial Day and on the Whangdoodle claim the next month.

Election of board members for the remaining year was done by member in good standing. The show at the Art Gallery was very well attended. The Art Gallery was paid \$40.00 for the use and extra expense. The need for a larger building was discussed, also the need to collect rock for the show table all year instead of just before the show. \$122.35 was made on this years rock table.

*Patsy Bethel
Historian*

May Program

The May program will be a presentation on the formation of amethyst geodes.

Phil Neuhoff

Juniors Report

The juniors will be receiving some material at the meeting this month.

The Juniors will meet in the room that they have met for the last two months.

The Rock & Gem Magazine question and answers are found on page 42 & 43. The answers are due by May 31, 2009. The prize will be a DVD "The new crystal hunter".

Thanks to Mr. & Mrs. McCreath for the youth special door prize that was won by Ann Cryer. Tess Cryer won the door prize from the general drawing. Three loupes were given to the youth that had not received one prior to this meeting.

*Ed Moser
Cell 340-8060
Juniors Chair*



Remember to collect and bring Teddy Bears to the meetings for our public service project. The bears and other stuffed animals are given to emergency personnel to give to the children at the scene of emergencies. Please give your animals to Debbie Knudsen or Skeeter Eversburg. **THANK YOU!**



Sunshine Lady

Arlene Bailey is the club sunshine lady. Her job is to send some cheer to members who are ill or just need some cheering up. But she needs your help in doing this job. If you know of someone who has been recently ill let her know so she can send them a card. Her phone number is 562-8030. Thank you in advance for your help.

In Remembrance

Mabe Taylor Life Member--

Passed away in December. She and her husband were life members of the Idaho Gem Club. Mabe was born in Idaho's Wood River Valley on July 12, 1918. Her family moved to Boise when she was nine years old. She graduated from Franklin High School and went on to attend the Boise Secretarial School in 1936. She worked several years for the Cash Bazaar and 15 years for Pacific Finance. She married the love of her life Richard L Taylor Jan 10, 1942. They were happily married for 59 years until Richard passed away on May 30, 2001. They were very active in the outdoors and enjoyed traveling to Arizona in the winter and fishing and camping in Idaho and Canada in the summers. This meant lots of rock hounding through out the various states and Canada. Mabe loved life and was loved by all her friends and family. I am sure that her reunion with Richard has given her great peace. We will miss our friend and fellow rock hound.

*In Loving Memory
Willa Renken*

MEMORIAL DAY WEEKEND FIELD TRIPS

This month, the choices are numerous; there won't be a caravan to any location from Boise.

AMFED, NFMS, & CFMS 20th – 25TH May, 2009

Davis Creek/Lassen Creek - Premier Obsidian Dig.

Sunstone Field Trip near Plush, Oregon - At the Dust Devil Mine & Public Collecting Areas for Sunstones.

This is in conjunction with the AMFED & Northwest Federation to Lassen Creek/Davis Creek over the May 20th – 25th, 2009 Memorial Day Weekend

http://www.amfed.org/field_trips.htm

The Dust Devil Mine is on the left side of the road when you are traveling north on CR 6115. Heading north from the Dust Devil Mine you will find the public collecting area. There are numerous claims in this area.

There is dry camping at the Public Collecting area, along with Public Latrines. Always remember if you pack it in be sure to pack it out as there is no dump service for this area.

No running water so be sure to bring plenty with you!

Tools needed: ¼ inch Screen, shovel, hammer, pick and chisels. This is hard rock mining! You can screen at the Public Collecting area, make sure you fill your holes!

Other Supplies: Full tank of gas, camping gear, cold weather & rain gear, food and water. This is the middle of the desert; services are a long ways away. Burns is about 2 hours, Plush and Lakeview are not very big. Bring everything you think you might want or need!

If you would like more information, please come to our Gem Club Meeting: May 19th, 7:30 p.m. at the Mountain View Church of the Brethren 2823 N. Cole Rd. or Call our Field Trip Chairman

*Tony Griffin
Field Trip Chairman
467-9286 home phone
863-5990 cell phone.
Email: tonygriffin@heritagewifi.com*

FROM THE EDITOR

The deadline for articles is the board meeting, if it needs to be typed. If the article is sent via e-mail the deadline is the Saturday after the board meeting.

Phone: (208) 362-3941
E-mail: WLR_DKR@MSN.COM
My mailing Address is:
Doug Renken
12843 S. Five Mile Rd.
Kuna ID, 83634

Welcome New Member

Scott & Susan Benda
725 W. Floating Feather Rd.
Eagle, ID 83616-3817
(208) 938-9398

Jim & Kinne Kirschbaum
260 W. River Trail Dr.
Eagle, ID 83616-7114
(208) 938-0282

Rodney Sharp
2791 N. Ridgebury Ave.
Meridian, ID 83646-7284
(208) 608-5856

Stuart & Patricia Wilcox
6033 N. Waterside Pl.
Garden City, ID 83714-1293
(208) 724-5254

"CODE OF ETHICS"

I will respect both private and public property and will do no collecting on privately owned land without permission from the owner.

I will keep informed on all laws, regulations or rules governing collecting on public lands and will observe them.

I will, to the best of my ability, ascertain the boundary lines of property on which I plan to collect.

I will use no firearms or blasting material in collecting areas.

I will cause no willful damage to property of any kind such as fences, signs, buildings, etc.

I will leave all gates as found.

I will build fires only in designated or safe places and will be certain they are completely extinguished before leaving the area.

I will discard no burning material - matches, cigarettes, etc.

I will fill all excavation holes which may be dangerous to livestock.

I will not contaminate wells, creeks, or other water supplies.

I will cause no willful damage to collecting material and will take home only what I can reasonably use.

I will practice conservation and undertake to utilize fully and well the materials I have collected and will recycle my surplus for the pleasure and benefit of others.

I will support the rockhound project H.E.L.P (Help Eliminate Litter Please) and will leave all collecting areas devoid of litter, regardless of how found.

I will cooperate with field trip leaders and those in designated authority in all collecting areas.

I will report to my club or federation officer, Bureau of Land Management or other authorities, any deposit of petrified wood or other materials on public lands which should be protected for the enjoyment of future generations for public educational and scientific purposes.

I will appreciate and protect our heritage of natural resources.

I will observe the "Golden Rule", I will use Good Outdoor Manners and will at all times conduct myself in a manner which will add to the stature and Public Image of Rockhounds everywhere.

THE GRINDINGS

is the monthly newsletter of the Idaho Gem Club, Inc., associated with the Northwest Federation of Mineralogical Societies. Permission to copy is freely granted when proper credit is given to both the publication and the author. Articles without bylines are written by the Editor or President.

CHECK OUT THE CLUB WEBSITE!

www.idahogemclub.com



Workshop Report

The workshops will begin this year on May 21st. Bring a slab to cab and come have some fun. We will start at 6:30p.m. and go until 9:30p.m. This is your opportunity to learn about the art of lapidary and get some experience within this field. We will also have wire wrapping so you can learn how and maybe make a gift or a piece of jewelry for yourself. There is a small charge for the wire for each project. All we ask is that you help clean up the machines at the end of the evening. We welcome one and all to 12843 S Five Mile Rd off of Kuna Rd. If you are interested there will be a sign up sheet at the next

meeting or you can give me a call. We hope you will come and enjoy the fellowship.

*Willa Renken
Workshop
Chairmen*

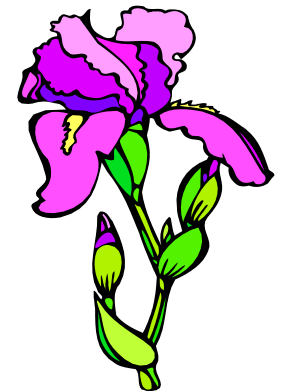
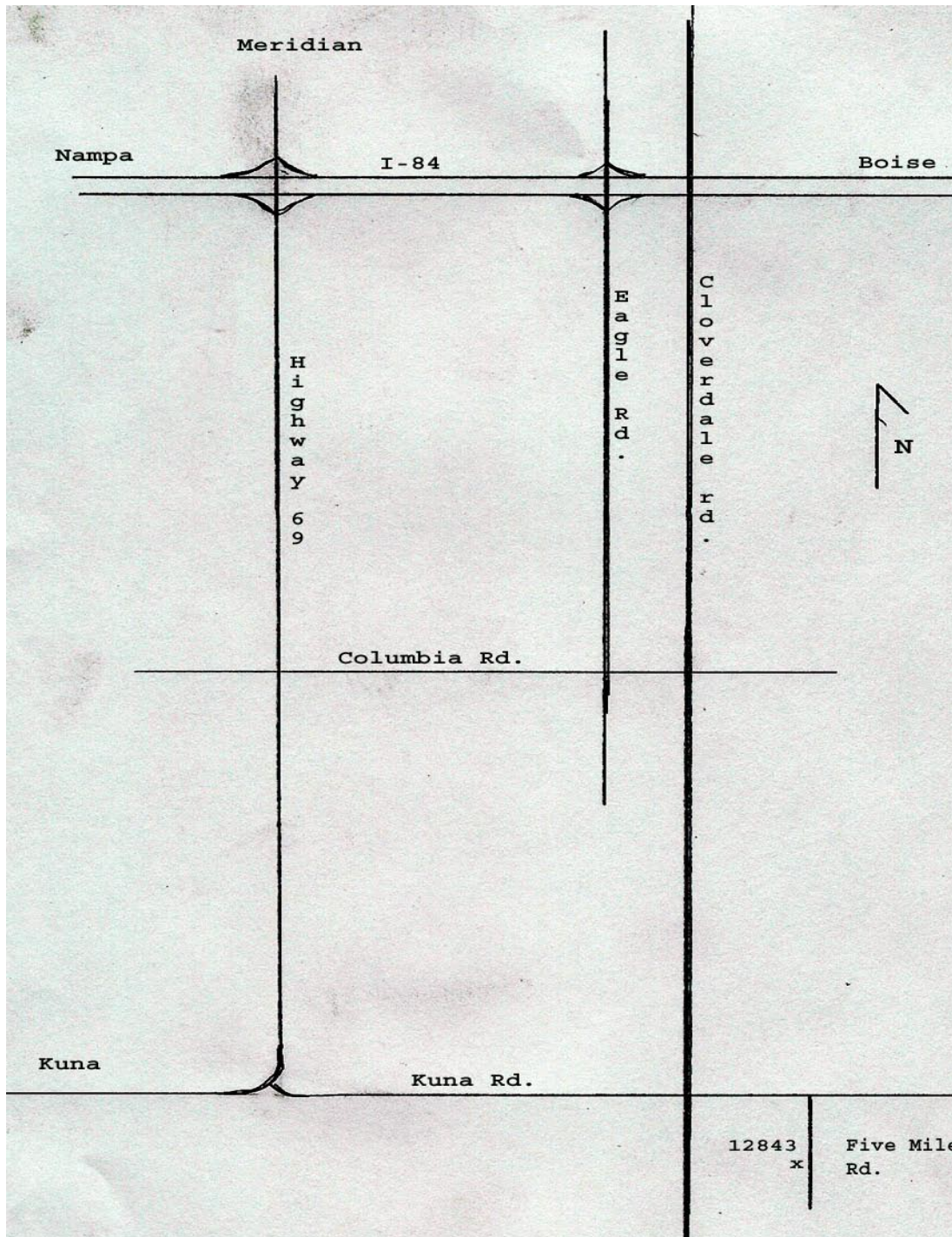

Workshop address:
12843 S. Five Mile Rd.
Phone 362-3941

The purpose of the Idaho Gem Club is to promote mutual, educational and scientific interests and benefits of its members in mineralogy, geology, gemology, the art of lapidary and kindred arts and sciences.

Dues:

- \$12.00 per person
- \$15.00 per couple
- \$17.50 per family

Subscription:

\$10.00 per year

General Meeting:

3rd. Tuesday of each
Month at 7:30 p.m.

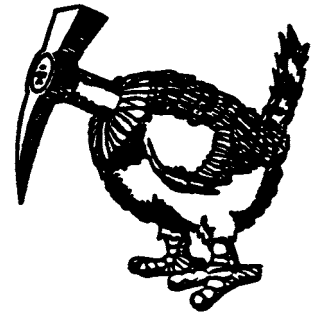
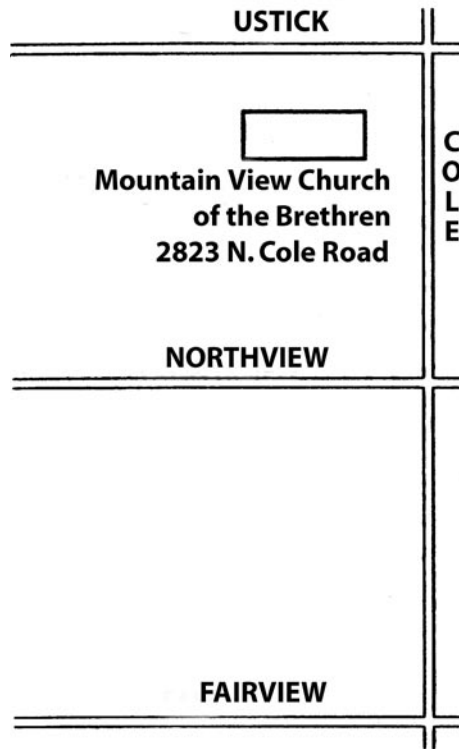

The Whangdoodle Bird
(Often seen on field trips)



Idaho Gem Club, Inc.

P.O. Box 8443
Boise, Idaho 83707-2443

HAPPY
Mother's Day