

Grindings

Idaho Gem Club, Inc.

P.O. Box 8443 ♡ Boise, Idaho 83707-2443

VOL 68 NO 10

October 2008



BOARD OF DIRECTORS

Catherine Parsons
President
465-1646

Willa Renken
1st Vice President
362-3941

Ilse Schreiner
2nd Vice President
362-2416

Joe Nielson
362-3522

Ed Moser
340-8060

Arlene Bailey
562-8030

Terry Tomberlin
343-7506

Tony Griffin
467-9286

Twila Gallaher
853-6703



**RECORDING
SECRETARY
OPEN**

TREASURER
Kathy Griffin
467-9286

NFMS DIRECTOR
Charles McCreath
344-5085

EDITOR
Doug Renken
362-3941
WLR_DKR@MSN.COM

CLUB WEB SITE
www.idahogemclub.com

President's Message

This is your club—we need your contributions to make it a success. I know that the current economy has really put a damper on a lot of your activities and attendance at meetings but we do need you!

The US Dept. of the Interior has prepared a pre-decisional Environmental Assessment of three different alternatives for a Travel Management Plan for the Murphy Sub region between Wilson and Castle Creeks. The comment period ends October 24. Please contact Ryan Homan, Recreation Planner in the Owyhee Field Office at (208) 896-5925 for more information. The information is also probably on their web site.

Brrrrr—sure hope you got one final nice summer rockhounding trip taken. This month, if the weather cooperates, and the “pathway” in is dry enough, we’ll be going up to our Beacon Hill claim. We’ve invited the Owyhee Gem and Mineral Society members also. Doug will contact the ranchers whose land we cross to make sure they have been notified of the trip. (We can only go up during the official field trips with the ranchers being notified in advance.)

The Mountain Home club is having their annual show on Saturday, Oct 18 at the Senior Center. It would be great if you could support them.

Auctions are scheduled for our November and December meetings. The funds raised help support funding for our banquet in January. The December auction is typically of completed items and many times you can finish your Christmas shopping then.

Please keep tumbling rocks, sewing grab bags, and preparing your “prizes” for your show case. Remember the dates for the show will be February 28-March 1 due to the Expo Center rescheduling events. Remember that this is YOUR show, and we need everyone’s contribution to make it a success.

We have plenty of cookbooks available for sale still—these books make wonderful Christmas gifts, etc.

The Board member nominating committee is being chaired by Ed Moser. Please contact Ed if you would like to be nominated or know someone who might be interested in serving as a Board member. We will be providing a brief biography for each of the nominees in November’s newsletter. We can also accept nominations from the floor during the November meeting.

The Project-of-the-Year contest is in December so you still have about 2 months to work on your project. Club members present will vote on their favorite project during that meeting. If it’s yours, you will get to display your work along with the plaque with your name on it during the show. We’ve had some wonderful entries through the years and I’m looking forward to seeing what you have made.

Happy Rockhounding!

Catherine Parsons
President

**MINUTES OF THE IDAHO GEM CLUB
GENERAL MEETING ♦
SEPTEMBER 16, 2008**

President Cathy Parsons called the meeting to order at 7:30 p.m. followed by the Pledge of Allegiance.

Marge Conley won the door prize.

A motion was made by Chuck McCreath to accept the minutes as printed in the Grindings. The motion was seconded by Tony Griffin and approved by the members.

An idea was presented to the members to get the Grindings from the Internet instead of being mailed USPS. The thought is to save on printing and postage expenses.

No Secretary or Treasurers Report.

Chuck McCreath asked members if they had been reading the Northwest Federation Newsletter, few answered in the affirmative. Chuck then reviewed what is found on each page of the Federation Newsletter.

Margaret Stallknecht, a guest, is the Education Director for the Northwest Federation. Margaret briefly explained her function with the Federation and stated members of the Idaho Gem Club could contact her with any questions about the operation of the Federation. Margaret also stated there will be a Show sponsored by the Stallknecht Rock & Gem Club in Vale, Or. on September 20th & 21st.

Tony Griffin gave the Field Trip Report; he stated an injury prevented him from leading the trip to War Eagle Mountain. A member of the Owyhee Gem & Mineral Society, Greig Voss, led the trip in Tony's place. Photos of the trip can be viewed on our Club Website. Our next field trip will be on September 20 & 21st, we will be going to our Sunstone Claim near Plush, Or. He reported there is also a Show and Field Trip at McDermitt, Ore. coming up the same weekend as our Field Trip.

Ron Bailey – R.O.L.E. Program Chair is still looking for individuals who want to learn to make cabochons or improve your techniques and to learn new techniques.

Rocky Rattlers Chair person Ed Moser described the Junior Merit Badge Program designed by the AMFED

(American Federation of Mineralogical Societies). The juniors can go to the AMFED.ORG website and download the details of this program then commit to learning about Gems and Minerals. Badges are awarded to each junior after completing the requirements for each badge.

Marge Connolly donated some fossil bones collected in Florida to the juniors.

Arlene Bailey gave the Sunshine Report: Joan Alvey has had surgery and is doing well.

Kristy Robinson, daughter of Harold and Dana Robinson was struck by a drunk driver; she is still in intensive care. There is a Victims Fund set up in Kristy's name at KeyBank. You can also send cards to her family.

Old Business

Chuck McCreath and Joe Nielson reported on the License Plates – we have a contact in the State Senate that is willing to sponsor the "Gem" license plate. This State Senator has gotten three special license plates approved and is also a member of the Idaho Transportation Committee. It was reported that a meeting with this Senator will be held on September 17th with members of the Idaho Gem Club committee delegated.

Cathy Parsons will be having a garage sale on Saturday September 20th from 9 a.m. til 4 p.m. Members can bring stuff to sell, but they will need to stay to help. Ten percent will be donated to the club.

Both of the Idaho Gem Club displays that were at the Idaho State Capitol building have been found, they are at the Idaho Museum of Mining & Geology.

Cathy Parsons has taken three books of old Idaho Gem Club minutes to be scanned and put onto a CD. Copies will be made available.

New Business

There will be a club rock wash & sort at Doug & Willa Renken's house on September 27th. These rocks are for the Idaho Gem Club Show coming up in 2009.

Meeting adjourned at 8:15 p.m.

A DVD of "Sedimentary Agates of the Dakotas, Nebraska, Montana, and Wyoming" was shown as a program after our refreshment break.

*Respectfully submitted,
Kathy Griffin,
Acting Secretary*

**MINUTES OF THE IDAHO GEM CLUB
BOARD MEETING ♦
OCTOBER 7, 2008**

President Cathy Parsons called the meeting to order at 7:30 p.m. The following board members and officers were present: Cathy Parsons, President, Joe Nielsen, Ed Moser, Arlene Bailey, Tony Griffin, Ilse Schreiner, Twila Gallaher, Terry Tomberlin, Kathy Griffin and Chuck McCreath. Guests were Doug Renken, Ron Bailey, and Shirley McCreath.

Terry Tomberlin made a motion to accept the minutes as printed in the "Grindings", Tony Griffin seconded the motion, the motion carried.

Secretary's Report – there were numerous Newsletters from other clubs, some magazines, and two applications for membership in the mail.

Treasurer's Report – Kathy Griffin was asked a question about the amount of a check written to Doug Renken for the club workshop/newsletter that did not have an amount on the August Treasurers Report. Kathy was absent when the check was written and the receipts seem to be missing. A search is in progress to locate the missing receipts. The amount of the check and an explanation of what the check was written for was given and approved; we just need the paper trail for justification. The check was reimbursement for newsletter postage and some items for workshops.

Federation Report – turn in stamps to Chuck McCreath for Federation collection. They are then sold and the amount raised is donated for Cancer Research.

Scholarship Report – Cathy Parsons found out that in previous years we had given the scholarship directly to BSU, Chuck McCreath explained this was discontinued because the scholarship didn't go to a Geology or Earth Science student.

Field Trip Report – Tony reported there were nine members in attendance at the Sunstone Claim. Doug Renken has taken some nice pictures of the trip including some of a lightning storm at night. Numerous sunstones were found at the claim and from the public collection area.

Beacon Hill will be our field trip for the month of October if the dirt roads are dry. We will be meeting at 8:30 a.m. on Saturday Oct. 25th at the I-84 Rest Area just over the Snake River bridge in Oregon. Departure time will be promptly at 9 a.m. The Owyhee Gem & Mineral Society will be joining us.

Ed Moser reported eleven youngsters have signed up for the American Federation Merit Badge program. The juniors will have to register by name with the Federation to qualify. An unnamed parent has volunteered to help with the juniors.

Arlene Bailey has sent flowers to the hospital for Kristy Robinson. She is doing better. Joan Alvey had surgery and is doing well, right now.

Old Business

License plates – the Senator sponsoring the bill said he will get someone from the House to sponsor the bill on that side. Committee Members from the Idaho Gem Club are preparing three to five minute presentations to be given at a joint Legislative Committee. Discussion on this matter was quite lengthy; an organization to manage the disbursement of this fund for perpetuity is the next step.

Tony Griffin made a motion for the Idaho Gem Club to accept in perpetuity the management and disbursement of the funds generated by the "GEM" license plate sales. Arlene Bailey seconded the motion. The motion carried with the exception of one "Nay" by Terry Tomberlin.

Doug Renken reported five people attended the "Rock Wash". The donated rock was cleaned and sorted. Doug reminded us the club Show is coming up and we as a club need to be more responsive to getting ready for this Show.

New Business

Terry Tomberlin reported he has found a nice speaker system as an adjunct to the projector for programs and to replace our Karaoke speaker system that died at the last general meeting. It was decided the club will purchase an amplifier with rear wireless speakers and a microphone. Arlene Bailey brought up the Victims Fund for Kristy Robinson. Ed Moser made a motion to send a \$100 check from the club to be sent to KeyBank in Kristy's name. Terry Tomberlin seconded, the motion carried.

Reminder - Club dues are due this month.

Elections will be held in November – biographies need to be completed by November 4th for the November Newsletter.

Public comment is due no later than October 24th on the Murphy Subregion Travel Management Plan. You can download or look at the plan on the BLM website or borrow a disc from the club.

Twila Gallaher made a motion to accept new members, Terry Tomberlin seconded. The motion carried, please accept and make them feel welcome: Nancy O'Keefe, Jason & Heather Madsen and family, Karen Rogers, Mike Eckert & Hannah Bowman as new members of the Idaho Gem Club.

Meeting adjourned at 9:40 p.m.

*Respectfully submitted,
Kathy Griffin
Acting Secretary*

Juniors Report

The American Federation has a merit badge program. There will be patches for those who have signed up, (Membership Badge) hopefully at the next meeting.

Ed Moser
Cell 340-8060
Juniors Chair

Rock Washing Party

I would like to thank Tom & Connie Duke, Marge & Gabe Conley, & Jim Dillion for coming out and helping clean the last of the donated rocks for the silent auction. I would also like to thank Cheryl Link for donating the buckets and lids used to put the clean sorted rocks into. This project has seemed to help organize the rocks for the silent auction at the annual gem show.

Doug Renken

Rock Sale

Oct. 17-19

9:am to 5:00 pm.

Rough, Slabs, Findings, Books & Magazines
Beading oven, copper & enameling, Misc.
3515 Kingsland Way, Boise

Food Drive for the Idaho Food Bank

We will be accepting donations for the Idaho Food Bank at our next meeting on October 21st. The Idaho Food Bank also accepts checks and cash donations. There will be a collection box if you want to donate. They ask you to concentrate on donating of nutritious foods. Children make up 32% of the recipients of this food and in Idaho 17,300 people a week use the State's Food Banks. Let's start out the Season of giving now when so many people need help.

Twila Gallaher

Yesteryear December 1951

The Board instructed the Secretary to write a letter of thanks to the Homedale Mayor for the use of the Park for the August Picnic. There was a Field trip discussion as to where the next field trip was to be and it was decided that the next one would be in the Sucker Creek Canyon Territory. Board members were served ice cream, home-made cake and a fruit drink.

Report was given on the Caldwell NWFMS Show where many nice displays were seen.

The trip to Sucker creek area was to be a hunt for green moss agate. The next trip was also to Sucker Creek for tube agate. They would cross the creek and end up near Graveyard Point.

No reports were given on the field trips but the one in October would be to Beacon Hill.

A report was given on the Beacon Hill trip and members were told how to cut and polish their agates.

Dues were now \$1.20 a year. The Christmas party was to have a gift exchange with the gifts being at least .50 cents in value.

The Christmas party was held at the Boise Art Gallery. The sophomores from the High School sang two numbers. There was a reading and a movie in color was shown. Mr. Root gave details of the last field trip in the Sucker Creek area. He said there were many arrowheads and everyone found some. Most were made of chert.

Santa rushed in giving every one a bag of candy with a number on it which matched the number on a gift. Cider, coffee and cookies were served. This ending 1952.

Patsy Bethel
Historian

October Program

The program for October will be a presentation by Rob Bolen on North American Indian Lithics.

Ilse Schreiner
Programs Chair

September Field Trip Report Sunstone Claim

It was a cold rainy day starting out early Saturday morning. Beautiful clouds hung low over many of the higher peaks in the distance. As time progressed and distance was covered, I found myself in those wispy clouds. If it weren't for the fact I knew this area is desert and it is near the end of September the area looked like early spring, just before flowers and grasses were about to bud out. By the time I reached Burns the rain was in isolated bands.

The drive to our sunstone claim is about six hours. The last sixty four miles is almost a straight shot through an area of very little plant life. The distant hills have plenty of juniper trees. According to BLM, fire control over the last century has caused the junipers to become more abundant, which is bad news for sagebrush. The junipers use the available water preventing sagebrush from growing.

The road to Plush is a fairly nice graded gravel road, lots of cattle, it is open range. The side roads can be well marked, at least the roads going to the Public Sunstone Area. The first eight miles after turning off the road to Plush is okay, but the last five miles heading towards our claim and Dust Devil are horribly washboard. You either had to drive two miles an hour (or make your own road) or sixty to jump over the washboard, which obviously you can't do.

There were nine attendees for this field trip. Two families had taken vacation and spent the week digging at the claim, looking for obsidian near Lakeview, Oregon, and generally having a good time. Doug said they had their share of rain, both hot and cool weather, and plenty of lightening storms to take pictures of. The weather was still cool on Saturday afternoon with no rain, but a little wind.

Plenty of nice sunstones were taken from our claim and two of the Fee Dig mines as well as some smaller sunstones from the public area. Sunstone is also called aventurine feldspar (a variety of oligoclase). Mineralized goethite or hematite is what gives sunstone the color gold, orange, red to red-brown, which is highly prized.

Nasty Flat Road is an alternate road to leave the Sunstone area. Go north on CR-6115 for about seven miles then west on Nast Flat Rd. for another seven or eight miles. This route cuts about ten miles off the route, but the road came by its name naturally. Metaphorically speaking, your tires won't appreciate the rocks and ruts that are prevalent. I blew one tire just after turning west, the tire is hopelessly shredded. Doug warned me to be careful, which I thought I was, the blowout states differently.

*Tony Griffin
Field Trip Chairman
467-9286 home phone
863-4248 cell phone.
Email: tonygriffin@heritagewifi.com*

HAPPY BIRTHDAY



OCTOBER

10/1 Kathy Menten
 10/4 Mike Ekert
 10/6 Dick Reed
 10/7 Chris Cox
 10/9 Cindy Woolsey
 10/10 Dennis Cockerham
 10/12 Jacan Habersetzer
 10/13 Larry Tomberlin
 10/22 Jim Dillion
 10/22 Betty Trebilcock
 10/22 Bryce Dethlefs
 10/22 Michael Eastlick
 10/24 Leroy Castle
 10/26 Christopher Griffin
 10/28 Sue Clark
 10/28 Allan Young
 10/29 Sandy Johnson
 10/30 Larry Bybee
 10/30 Chuck Murphy

October Birthstones
Faceted — Tourmaline
Cabochon — Opal

NOVEMBER

11/1 Peggy Dean
 11/2 Robert Griswold
 11/5 Tom Johnson
 11/6 Tom Menten
 11/7 Peggy Blickfeldt
 11/7 Terrie Bybee
 11/9 Maria Longstroth
 11/12 Penny Dudley
 11/14 Robert Burns
 11/20 Judy Clymens
 11/21 Gary Hanes
 11/22 Christa Wakefield
 11/23 Marge Conley
 11/24 Gary Smith
 11/28 Amanda Loewen
 11/28 Robert Hoffman
 11/28 Diane Perkins
 11/29 Ferman Ansel

November Birthstones
Faceted - Topaz or
Citrine
Cabochon — Amber

Upcoming Show

Mountain Home Gem Show
October 18th
Senior Center
1000 N. 3rd E.
Mountain Home, Idaho

DATES TO REMEMBER

GENERAL MEETING:
3rd. Tuesday of every month
 October 21, 2008
 Church of the Brethren
 2823 N. Cole Road, Boise, Idaho
 Meeting Starts at 7:30 pm.

BOARD MEETING:
1st. Tuesday of every month
 November 4, 2008
 Church of the Brethren
 2823 N. Cole Road, Boise, Idaho
 Meeting Starts at 7:30 pm.

October Refreshment Committee

Chair: Richard & Sue Clark 336-6930
 Jim Storey 376-0044
 Jean Dingley 377-2713
 Jim & Belle Witt 362-6042

REFRESHMENT COMMITTEE GUIDELINES

Need approximately 15 dozen cookies. Wrapped door prizes are also needed. Arrive early enough to set up the chairs. The chairperson brings the coffee urn, coffee, punch, cream, sugar, cups and napkins. Afterward, put meeting tables & chairs away, clean kitchen and sweep the room. Gather and take all the trash with you. Don't forget it is the responsibility of the chair for the coming month to pick up the coffeepot, take it home and bring it the next meeting.

November Refreshment Committee

Chair: Open
 Debbie Knudsen 322-5527
 Nancy Schlossman 322-5527
 Randy Knudsen 939-8365

IDAHO GEM CLUB OCTOBER FIELD TRIP

Beacon Hill Claim

What: We will be collecting geodes from our claim. These are especially nice, colorful and hard specimens.

When: Saturday Oct 25th, weather permitting.

Where: We will meet at the Rest Area just over the Snake River in Oregon between 8:30 am and 9 am, leave promptly at 9 a.m. We will travel on I-84 to exit 374 (Hwy 201), the last Weiser exit off I-84. From there we will travel on Hwy 201 towards Weiser to the Junction of Hwy 201 & Hwy 95. Go right on Hwy 95 through Annex, Or.; just over the Snake River we will turn right, before going under the Rail Road bridge. Go left at the stop sign, travel until the pavement ends and goes right, this is Eaton Rd. Take this right and go to the next stop sign at Olds Ferry Rd. Take a left here and just past the curve in Olds Ferry Rd at the Snake River, a dirt road will go off to the right through a gate. This dirt road goes 5.3 miles into the hills where our claim is located. In some places the road is for high clearance vehicles only.

From the Garrity exit (Exit 38) to the top of our claim is 70.2 miles. Travel time is a little under two hours from this exit.

Equipment: you will need a shovel, pick, rock hammer. The ground has been worked with a grader earlier this year making it loose, but there are numerous rocks making the digging difficult. If you like small geodes bring a screen with a maximum ½ inch hole or smaller.

Bring a lunch, water, good walking shoes/boots, sunscreen, sunhat, and any personal items you require.

*Tony Griffin
Field Trip Chairman
467-9286 home phone
863-5990 cell phone.*

Email: tonygriffin@heritagewifi.com

OWYHEE GEM & MINERAL SOCIETY OCTOBER FIELD TRIP

Trip Location: Beacon Hill Claim

Date of Trip: Saturday, October 25th

Meeting Place: I-84 Rest Area across Snake river before Ontario Oregon.

Leave Time: Meet 8:30 a.m. leave 9:00 a.m.

Comments: Shovel, Pick, Rock Hammer, bucket, Lunch, lots of water or soda. A high clearance vehicle is required to drive the last five mile to the claim. This will be a joint field trip with the Idaho Gem Club.

*Walter Barnett
(541) 889-3672*

DUES ARE NOW DUE.

Rates are as follows:

*\$12.00 per person
\$15.00 per couple
\$17.50 per family*

*Dues are due by October 31 each year .
Please pay at the next meeting or send
them to*

*Kathy Griffin, Treasurer
P.O. box 8443
Boise, ID 83707-2443*

What to Look for When Hunting Crystals in Idaho

By: Tony Griffin – IGC Field Trip Coordinator

Pegmatites

Pegmatite bodies have a relatively larger grain size than the surrounding igneous rocks. Individual crystals are known to reach more than 30 feet in length. A pegmatite may have the composition of a granite, diorite or gabbro. All three types are exposed in the large granitic plutons of Idaho. However the granitic pegmatites are by far the most common. In practically every exposure of granitic rock in the state, there are one or more granitic pegmatite dikes exposed. Although most of these pegmatites do not exceed 10 feet in thickness; an uncommonly large pegmatite more than 300 feet along its smallest dimension is exposed in the City of Rocks near the town of Oakley.

The extremely large crystal size (generally 2 to 8 inches), is attributed to both slow cooling and low liquid viscosity. Pegmatites are the last portion of a pluton to crystallize. These residual fluids are much richer in certain elements than the original magma. High amounts of silica and ions of elements that are necessary to crystallize sodium plagioclase and potassium feldspar must be abundant in the fluids. The fluids are also rich in certain elements that could not be used in the crystal structure of the previously crystallized minerals. Water is also very abundant which promotes slower cooling and a lower temperature of crystallization. Many pegmatites were intruded along existing fractures.

Most Idaho pegmatites are composed of orthoclase feldspar, quartz and muscovite. Careful inspection will also reveal small red garnets, black tourmaline and bluish-green aquamarine. Aquamarine is generally only found in the tertiary plutons.

Types of Plutons

Dikes are small tabular plutons which cut across layering in the host rocks. Dikes may range from one inch to tens of feet thick. They are much longer than wide and can commonly be traced a mile or more. Dikes are generally intruded along fractures and tend to have the composition of pegmatite, aplite (white, sugar-textured dikes) and basalt. In almost every road cut through the Idaho Batholith of central Idaho, aplitic and pegmatitic dikes can be seen.

Sills are also tabular bodies of the same approximate size and shape range as dikes. However, sills are concordant or parallel to the layers of the surrounding host or country rock. The Purcell sills are examples of such plutons in northern Idaho.

The largest plutons consist of granite and diorite and are found in the cores of mountain ranges. The Idaho Batholith is a good example. A batholith is defined as a pluton with a surface exposure in excess of 40 square miles. If the exposure is less than that, the pluton is called a stock. It is commonly believed that buried batholiths underlie large areas of widespread silicic volcanics in Idaho. Many of the large batholiths such as the Idaho Batholith are known to be a composite of many granitic plutons.

Continued on page 9

Continued from page 8

Used with permission for educational purpose
<http://imnh.isu.edu/digitalatlas/geo/rocks/rocks.htm>

Of particular interest on our Field Trips to Wagontown and Silver City, pegmatites and smaller crystal formations are found in granite in the mountains all along Jordan Creek up to and including, but not restricted to, the War Eagle Mining District.

Other sources:
<http://www.pegmatology.com/>

Lolo Pass - <http://www.gemandmineral.com/lolopass.html>

Big Horn Crags - <http://www.gemandmineral.com/bighorncrags.html>

Welcome New Members

Kaveu Rogers
730 S. Willis Ave.
Kuna, ID 83634-3022
(208) 922-3306

Mike Ekert & Mary Ann Bowman
Hannah Rose Bowman
7323 San Fernando Dr.
Boise, ID 83704-5953
(208) 602-4226

Nancy O'Keeffe
5737 Garrett St Apt 203
Garden City, ID 83714-2212
(208) 321-4394

Jason & Heather Madsen Family
864 S. Wild Phlox Pl.
Boise, ID 83709-1785
(208) 378-4666

Rockhound Humor

YOU MIGHT A ROCKHOUND IF . . .

- 1. When they haven't seen you for a week, rock shop owners send you get well cards.**
- 2. You're retired and still thinking of adding another room to your house.**
- 3. Your idea of a "quiet, romantic evening at home" involves blue mineral tack and thumbnail boxes.**
- 4. You're planning on using a pick and shovel while you're on vacation.**
- 5. You can point out where Tsumeb is on a world globe.**

SAVE STAMPS

Just a note to remind people to save their postage stamps to donate to the Federation. The stamps are sold and the proceeds are donated to cancer research. Cut at least 1/4 inch margin around the stamps. You can turn them into Chuck McCreath at our next meeting. **THANK YOU!**

FROM THE EDITOR

The deadline for articles is the board meeting, if it needs to be typed. If the article is sent via e-mail the deadline is the Saturday after the board meeting.

Phone: (208) 362-3941
E-mail: WLR_DKR@MSN.COM
My mailing Address is:
Doug Renken
12843 S. Five Mile Rd.
Kuna ID, 83634

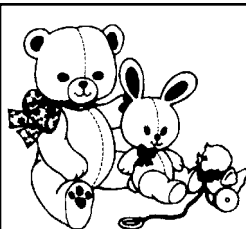

Remember to collect and bring Teddy Bears to the meetings for our public service project. The bears and other stuffed animals are given to emergency personnel to give to the children at the scene of emergencies.

*Please give your animals to Debbie Knudsen or Skeeter Eversburg. **THANK YOU!***



Sunshine Lady

Arlene Bailey is the club sunshine lady. Her job is to send some cheer to members who are ill or just need some cheering up. But she needs your help in doing this job. If you know of someone who has been recently ill let her know so she can send them a card. Her phone number is 562-8030. Thank you in advance for your help.

Sunshine Report

Flowers were sent to Kristy Robinson who is recovering from injuries in a car accident. Kristy - we hope you are doing much better.

Arlene Bailey
Sunshine Lady

"CODE OF ETHICS"

I will respect both private and public property and will do no collecting on privately owned land without permission from the owner.

I will keep informed on all laws, regulations or rules governing collecting on public lands and will observe them.

I will, to the best of my ability, ascertain the boundary lines of property on which I plan to collect.

I will use no firearms or blasting material in collecting areas.

I will cause no willful damage to property of any kind such as fences, signs, buildings, etc.

I will leave all gates as found.

I will build fires only in designated or safe places and will be certain they are completely extinguished before leaving the area.

I will discard no burning material - matches, cigarettes, etc.

I will fill all excavation holes which may be dangerous to livestock.

I will not contaminate wells, creeks, or other water supplies.

I will cause no willful damage to collecting material and will take home only what I can reasonably use.

I will practice conservation and undertake to utilize fully and well the materials I have collected and will recycle my surplus for the pleasure and benefit of others.

I will support the rockhound project H.E.L.P (Help Eliminate Litter Please) and will leave all collecting areas devoid of litter, regardless of how found.

I will cooperate with field trip leaders and those in designated authority in all collecting areas.

I will report to my club or federation officer, Bureau of Land Management or other authorities, any deposit of petrified wood or other materials on public lands which should be protected for the enjoyment of future generations for public educational and scientific purposes.

I will appreciate and protect our heritage of natural resources.

I will observe the "Golden Rule", I will use Good Outdoor Manners and will at all times conduct myself in a manner which will add to the stature and Public Image of Rockhounds everywhere.

THE GRINDINGS

is the monthly newsletter of the Idaho Gem Club, Inc., associated with the Northwest Federation of Mineralogical Societies. Permission to copy is freely granted when proper credit is given to both the publication and the author. Articles without bylines are written by the Editor or President.

CHECK OUT THE CLUB WEBSITE!

www.idahogemclub.com



Workshop Report

Your October workshop will be on Thursday October 23rd at 6:30 pm. I will be needing volunteers to help instruct so please let me know if you can help. This is your opportunity to learn about the art of lapidary and get some experience within this field. All we ask is that you help clean up the machines at the end of the night. If you are interested in attending give me a call. We usually have about eight people at a time. Marge has been helping those who have an interest in wirewrapping to get started. We are located at 12843 S Five Mile Rd off of Kuna Rd. See you at the meeting.

*Willa Renken
Workshop
Chairmen*

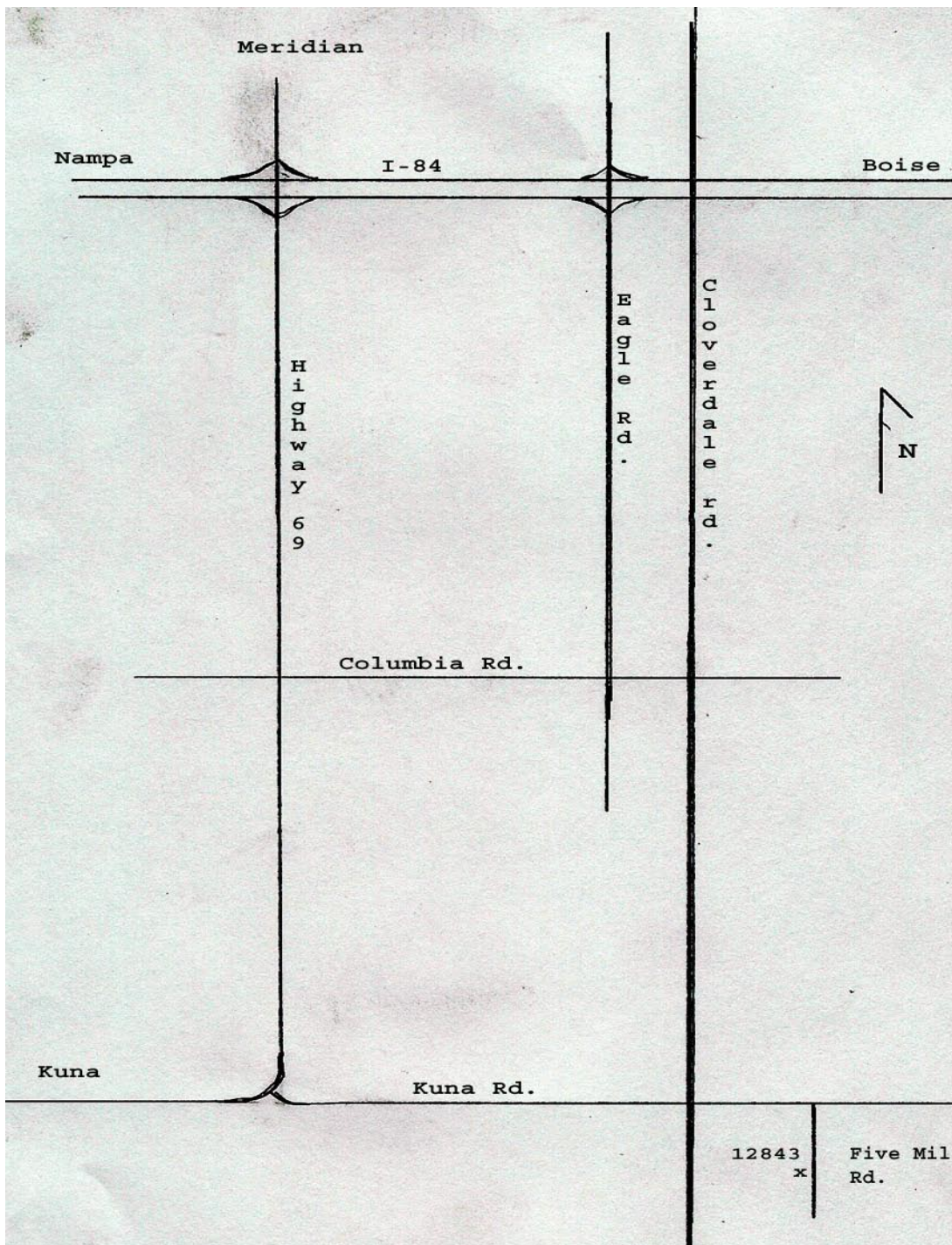

Workshop address:
12843 S. Five Mile Rd.
Phone 362-3941

The purpose of the Idaho Gem Club is to promote mutual, educational and scientific interests and benefits of its members in mineralogy, geology, gemology, the art of lapidary and kindred arts and sciences.

Dues:

\$12.00 per person
 \$15.00 per couple
 \$17.50 per family

Subscription:

\$10.00 per year

General Meeting:

3rd. Tuesday of each
 Month at 7:30 p.m.

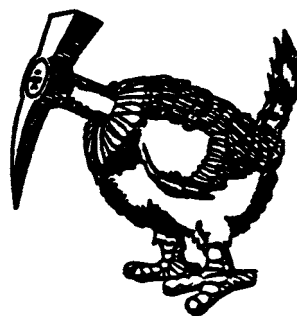
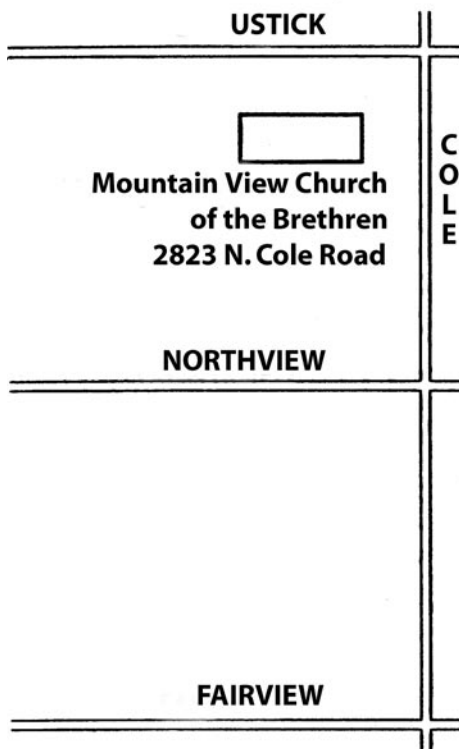

The Whangdoodle Bird
 (Often seen on field trips)



Idaho Gem Club, Inc.

P.O. Box 8443
 Boise, Idaho 83707-2443

